

134TH & ARAPAHO 133RD & BLACKFOOT

OLATHE, KANSAS 66062

LAND FOR SALE | 2.9 ACRES AND 3 ACRES

VILLAGE CENTER SQUARE

Are you ready to own
your own building?

PROPERTY FEATURES

- Zoned C-2 (General Business District)
- Adjacent to 51,000 SF Cottonwood Springs Hospital & 24 Hour Fitness
- **Ideal for medical, office, bank, or retail**
- Retail pad sites
- Divisible

ADDITIONAL INFO

TOTAL SIZE	2.9 Acres at 134 th Place & Arapaho 3.0 Acres at 133rd St. & Blackfoot
SALE PRICE	\$7.95 PSF



For more information, please contact:

WALLY RIST
Industrial Brokerage & Land Sales
816.936.8580
wrist@kessingerhunter.com

CASSIDY MEARS, MBA
Office Brokerage
816.936.8527
cmears@kessingerhunter.com

KESSINGER/HUNTER & COMPANY, LC
2600 Grand Boulevard, Suite 700
Kansas City, MO 64108
816.842.2690
www.kessingerhunter.com

134th & ARAPAHO & 133RD & BLACKFOOT, OLATHE, KANSAS 66062

Land for Sale

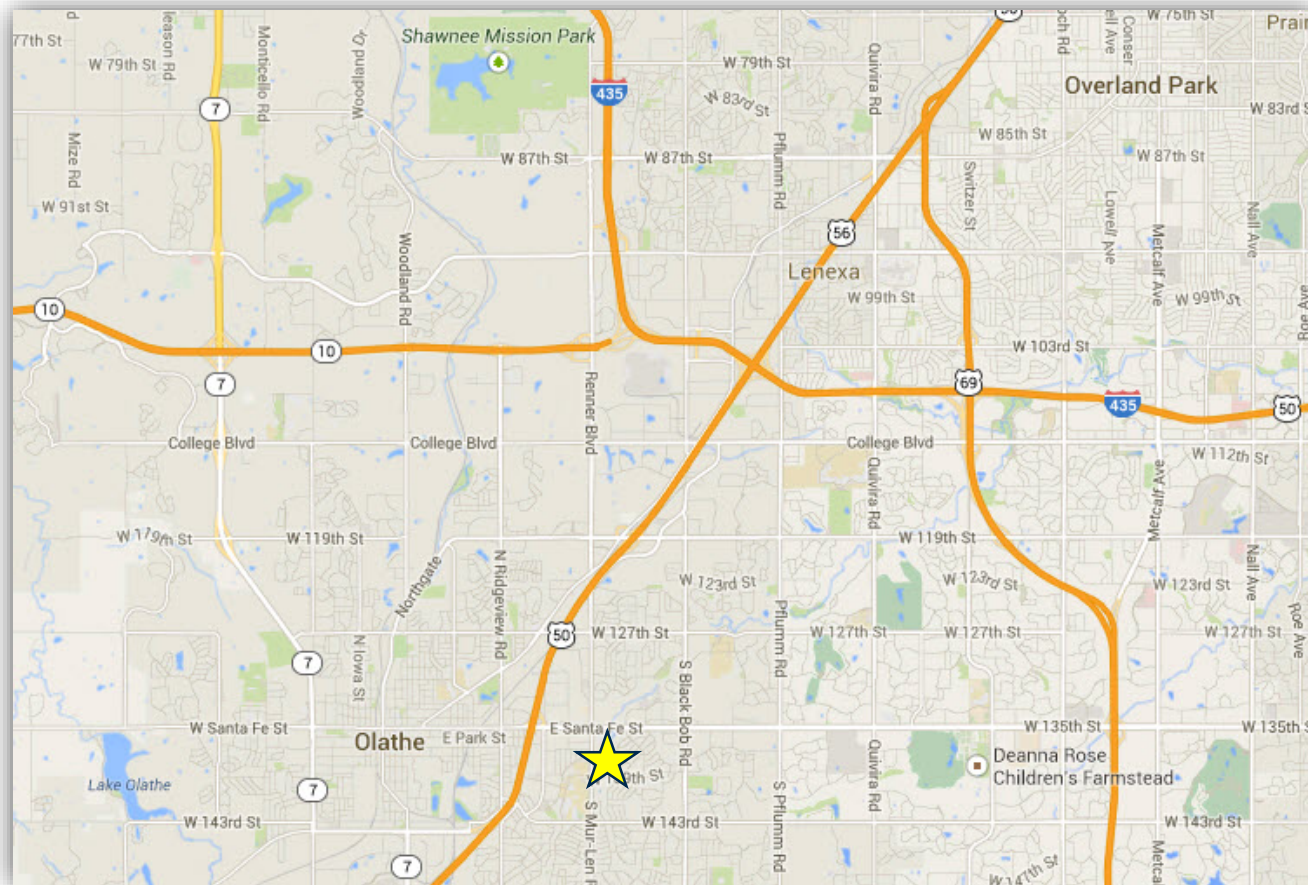

For more information, please contact:

WALLY RIST
Industrial Brokerage & Land Sales
816.936.8580
wrist@kessingerhunter.com

CASSIDY MEARS, MBA
Office Brokerage
816.936.8527
cmears@kessingerhunter.com

KESSINGER/HUNTER & COMPANY, LC
2600 Grand Boulevard, Suite 700
Kansas City, MO 64108
816.842.2690
www.kessingerhunter.com