

CORDOBA BUILDING 460 NICHOLS ROAD

KANSAS CITY, MISSOURI 64112

OFFICE FOR LEASE | 1,285± & 2,726± SF AVAILABLE



RENTABLE BUILDING AREA	45,970± SF
BASE RENTAL RATE	\$27.00 PRSF
LEASE TYPE	Full Service Gross

BUILDING FEATURES

- Located in the heart of the World Class Country Club Plaza
- Loft-high ceilings and 11' windows
- Dramatic lobby with distinctive entrance
- Street level lobby with mid-Plaza shopping/restaurant access
- Immediate access to adjacent parking garage
- 24-hour, on-site Plaza Security

SPACE AVAILABILITY

Suite 335	1,285± RSF
Suite 345	2,726± RSF

FOR MORE INFORMATION, PLEASE CONTACT:

KATHY LAPP

Office Brokerage
816.936.8534
klapp@kessingerhunter.com

DEBBIE SCHULTE, SIOR

Principal, Office Brokerage
816.936.8549
dschulte@kessingerhunter.com

KESSINGER/HUNTER & COMPANY, LC

2600 Grand Boulevard, Suite 700
Kansas City, MO 64108
(816) 842-2690
www.kessingerhunter.com

460 NICHOLS ROAD, KANSAS CITY, MISSOURI 64112

Office for Lease

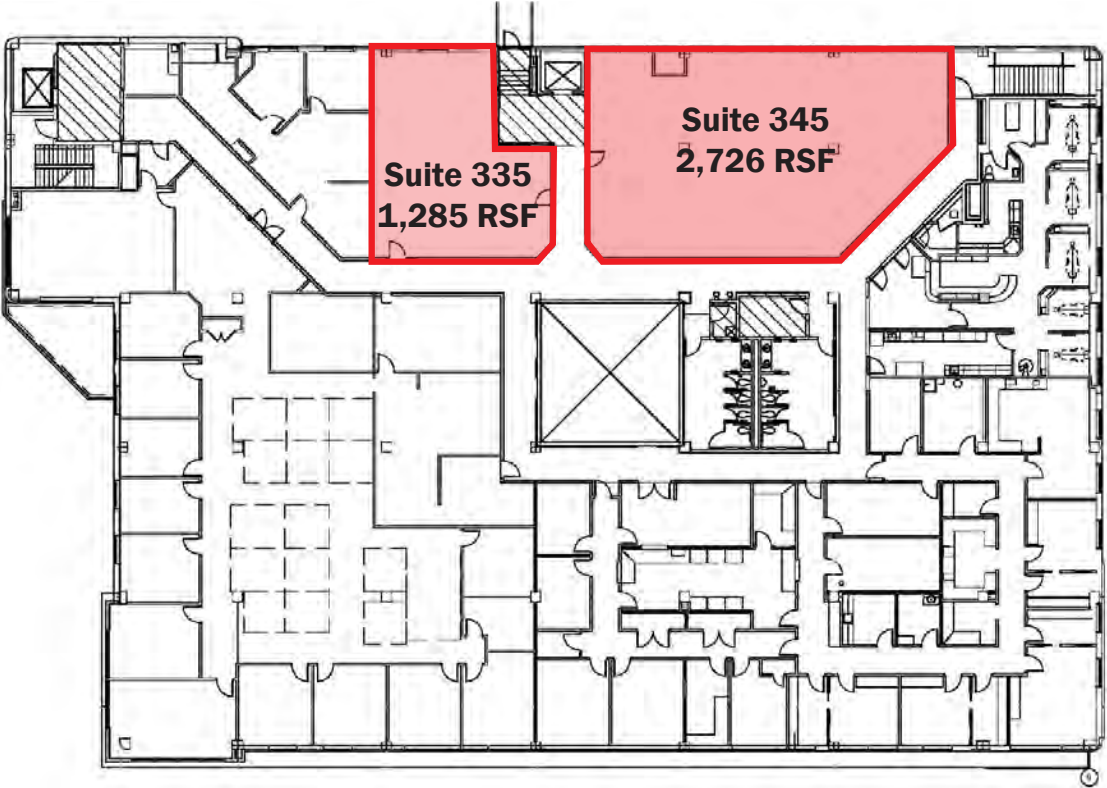

FOR MORE INFORMATION, PLEASE CONTACT:

KATHY LAPP
Office Brokerage
816.936.8534
klapp@kessingerhunter.com

DEBBIE SCHULTE, SIOR
Principal, Office Brokerage
816.936.8549
dschulte@kessingerhunter.com

KESSINGER/HUNTER & COMPANY, LC
2600 Grand Boulevard, Suite 700
Kansas City, MO 64108
(816) 842-2690
www.kessingerhunter.com

Information subject to verification and no liability for errors or omissions is assumed. Price subject to change.
To unsubscribe, please click on the link: khlistings@kessingerhunter.com