

9807 LACKMAN LENEXA, KANSAS 66219

INDUSTRIAL SPACE FOR LEASE | 21,710± SF

PROPERTY FEATURES

- Visibility to Lackman Road
- 4 dock-high doors
- Great access to I-435 & I-35
- 18'-20' clear height in warehouse
- Wet sprinkler system
- **Heavy power – 800 amp, 480 volt**
- **Air-conditioned warehouse**

ADDITIONAL INFO

TOTAL SIZE	21,710± SF with 1,300± SF of office space
LEASE RATE	\$4.00 PSF Net
TAXES	\$1.36 PSF
INSURANCE	\$0.10 PSF
TIMING	April 1, 2017

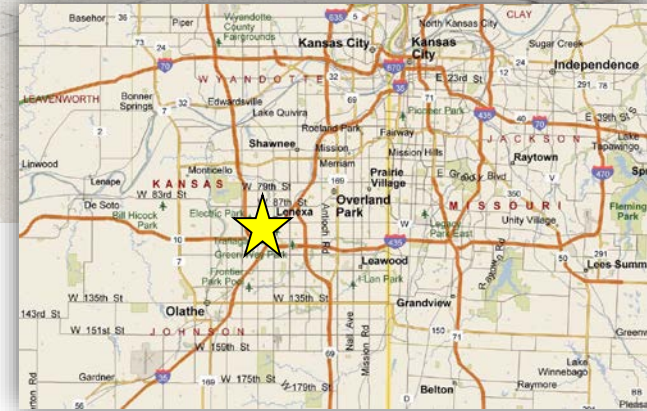

For more information, please contact:

MATTHEW SEVERNS, CCIM
Industrial Brokerage
816.936.8543 direct
mseverns@kessingerhunter.com

KESSINGER/HUNTER & COMPANY, LC
2600 Grand Boulevard, Suite 700
Kansas City, MO 64108
816.842.2690
www.kessingerhunter.com

9807 LACKMAN, LENEXA, KANSAS 66219

Industrial Space for Lease

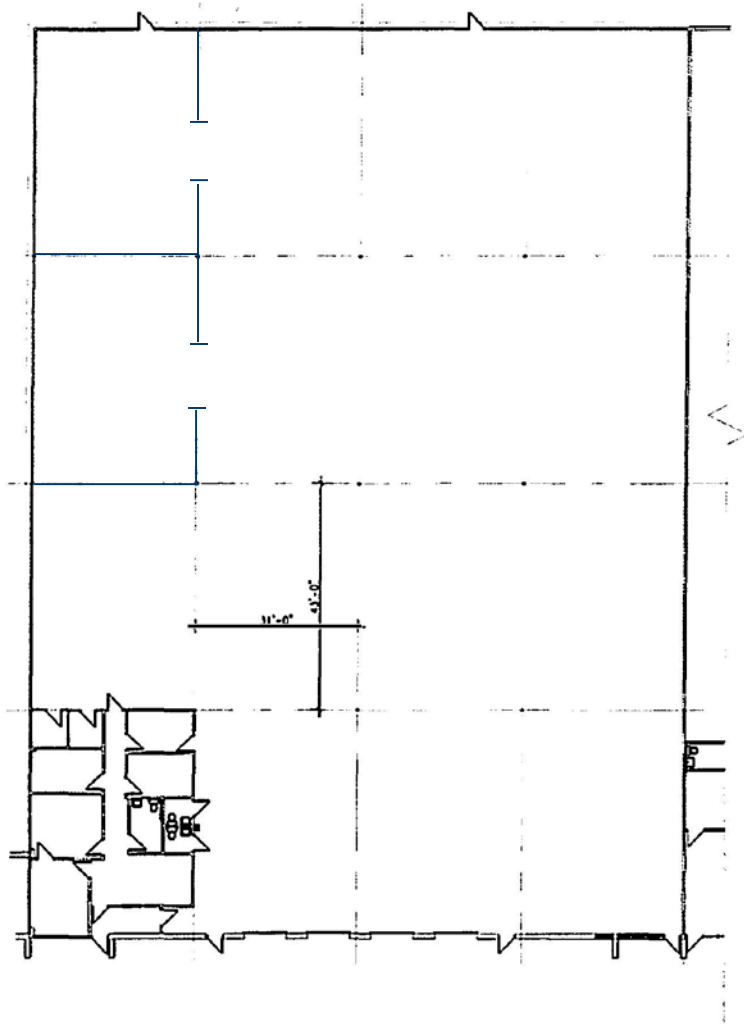

For more information, please contact:

MATTHEW SEVERNS, CCIM
Industrial Brokerage
816.936.8543 direct
mseverns@kessingerhunter.com

KESSINGER/HUNTER & COMPANY, LC
2600 Grand Boulevard, Suite 700
Kansas City, MO 64108
816.842.2690
www.kessingerhunter.com