

11641 W. 83RD TERRACE
LENEXA, KANSAS 66214

INDUSTRIAL SPACE FOR LEASE | 4,320± SF

QUIVIRA BUSINESS PARK

PROPERTY FEATURES

- Attractive Business Park Setting
- Flexible Office Sizes and Layouts
- Drive-In Loading
- Convenient Access to I-35
- Locally Owned and Managed
- Zoned BP-2 (Business Park)
- Built in 1981
- 14'4" Clear Height
- 4 Drive-In Doors
- 200 Amp | 120/208 Volt | 3-Phase Power

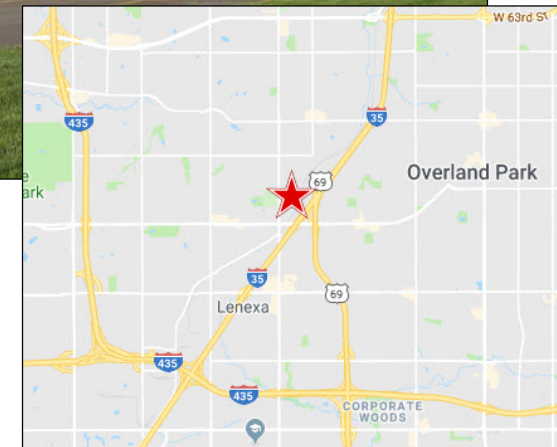

ADDITIONAL INFO

PREMISES	4,320± SF with 2,705± SF of office space
LEASE RATE	\$5.95 PSF Net \$1.84 PSF Taxes \$0.11 PSF Insurance \$1.40 PSF CAM

For more information, please contact:

MATTHEW SEVERNS, CCIM
Industrial Brokerage
816.936.8543 direct
mseverns@kessingerhunter.com

KESSINGER/HUNTER & COMPANY, LC
2600 Grand Boulevard, Suite 700
Kansas City, MO 64108
816.842.2690
www.kessingerhunter.com

11641 W. 83RD TERRACE, LENEXA, KANSAS 66214

Industrial Space for Lease

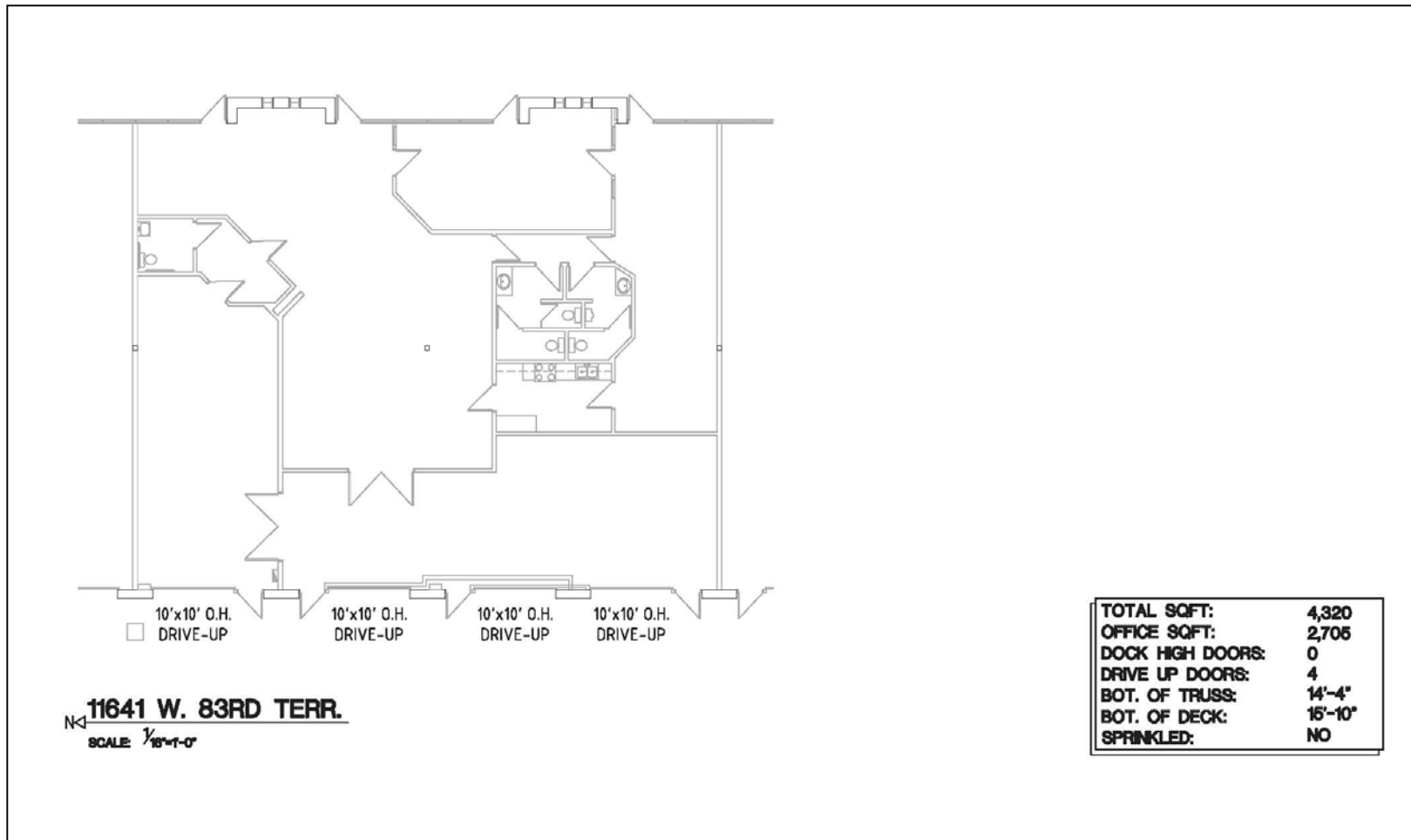

For more information, please contact:

MATTHEW SEVERNS, CCIM
Industrial Brokerage
816.936.8543 direct
mseverns@kessingerhunter.com

KESSINGER/HUNTER & COMPANY, LC
2600 Grand Boulevard, Suite 700
Kansas City, MO 64108
816.842.2690
www.kessingerhunter.com